

## White Columns SAPA Contest February 13, 2010

Milton High School  
13025 Birmingham Highway  
Milton, Georgia

### **Welcome**

The directors, staff, students and parents of the Milton High School Band welcome you to the White Columns Winterguard and Indoor Drumline SAPA Contest. We look forward to having your unit join us. Please find the following informational materials within this document or under separate PDF files. We hope this information will make your day at the White Columns SAPA Contest more enjoyable.

- Unit Information Packet
- Release Form
- Housing Contract
- Practice Site Contract
- Unit Spiel Sheet
- Directions to Milton High School
- Parking and Entrance Map
- Performance and Warm-up Area Map
- Overhead View of Milton Campus

Please do not hesitate to call or email any questions you might have:

Contest Emergency Contact: Mark Kapral  
770 778-2772  
kapral@fulton.k12.ga.us

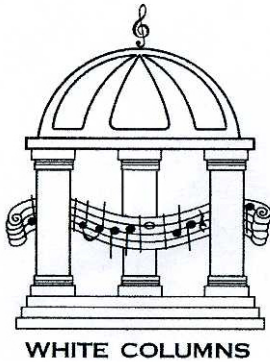

## White Columns SAPA Contest February 13, 2010

Milton High School  
13025 Birmingham Highway  
Milton, Georgia

**Sponsor Contact: Mark Kapral**  
**Emergency Phone No.**  
**770-778-2772**

**Directions to School:** See PDF map. PLEASE SHARE THIS WITH YOUR BOOSTERS AND PARENTS.

**Guard / Drumline Check-In:** See PDF map and PDF Site photo. Unit check-in is located in the front atrium. Be prepared to declare the number of competing members. Competing members plus seven staff members will be admitted. Additional members and staff must purchase tickets. Units must check in no later than **one hour** prior to performance time. ***At that time units must turn in the spiel sheet, meal pre-orders and release form.*** Guard members and staff must check in together.

**Admission:** SAPA policy is that each unit will be allowed to bring (7) staff members into the show in addition to the competing members. Additional passes may be purchased at the SAPA ticket price of \$8.00 for the day. This applies to floor crew staff and chaperones that exceed the allowed (7) staff members.

**Admission Prices:** As per the official SAPA admission prices, a one-day ticket will be \$8.00. No credit cards or checks will be accepted. Please share this information with your boosters and parents.

**Housing:** Housing will be offered in classrooms on site as space allows for a charge of \$3.00 per competing member as per SAPA Guidelines. A housing contract is enclosed. **The cooking of food IS NOT allowed on the school campus. The consumption of food or drinks IS NOT allowed in any areas of the school except the gym and concession area.** Please contact Mark Kapral for housing availability at [kapral@fulton.k12.ga.us](mailto:kapral@fulton.k12.ga.us) or 770-778-2772.

**Dressing Facilities:** Each unit will be given hallway space to store equipment and bags (this does not apply to props). Restrooms are located at the end of each hallway for changing. Please do not leave anything in the restrooms while you are not there. There will be hallway monitors, but please secure valuables, as we cannot be responsible for lost or stolen items.

**Practice Site:** Practice space is available at \$20.00 per ½ hour. A practice site contract is enclosed. Please contact Mark Kapral for practice site availability at [kapral@fulton.k12.ga.us](mailto:kapral@fulton.k12.ga.us) or 770-778-2772.

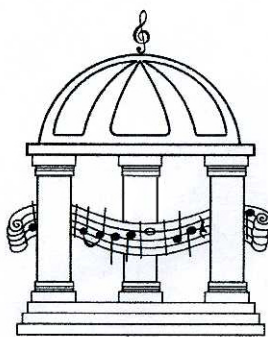

WHITE COLUMNS

## White Columns SAPA Contest February 13, 2010

Milton High School  
13025 Birmingham Highway  
Milton, Georgia

**Guard Warm-Up Area:** Please see attached maps. The warm-up area is in the auxiliary gym. The gym is regulation size with a hardwood floor and no ceiling obstacles. The gym will be divided on the vertical midway into two warm-up areas – Area A and Area B. There will be two guard units in the auxiliary gym at any time, one unit assigned to Area A and one unit assigned to Area B. Each guard unit will have both body and equipment warm-up in their assigned area. See enclosed performance & warm-up gym map. **Inspection:** Located in warm-up area.

**Drumline Warm-Up Area:** Please see attached maps. Drumline units will warm up in the Auditorium, Area A and the Band room, Area B. Prop and Equipment drop-off is located at the back of the school, with Area A and Area B easily located through a side entrance into the school. There will be an escort and plenty of volunteers to direct you.

**Prop Entrance:** The cafeteria will be divided into bay storage areas and you will be assigned a number for that storage area. Props can only be unloaded at the prop entrance one hour prior to performance time. There are no exceptions.

**Floor size:** The maximum allowable tarp size for any unit is 60' X 90'. The competition area is at least 75' X 110' from bleacher to bleacher, wall to wall. There **MUST** be a 5' buffer on all sides of the floor covering. **THE COMPETITION TIMELINE IS VERTICAL.**

**Footwear and Equipment Protection:** All equipment tips on rifles and sabers must be padded and taped. Any props and floor carts used must be protected so as not to damage the floor. Soft-soled shoes need no added protection. Hard-soled shoes must be taped. Performers **MUST** wear shoes at all times when **NOT** in the competition area.

**Tabulating and Judging Area:** These areas are off limits to everyone except authorized personnel. Pick up cassettes at the designated area shortly after your units' performance. **DO NOT APPROACH THE TABULATION TABLE!**

**Score Sheets and Recaps:** Can be picked up after retreat at the tabulation table.

**Awards:** Top 3 units in each SAPA Color Guard Class and Drum Line Class will receive a trophy. All other units will receive a certificate of participation.

**Critique:** The Contest Director will determine the details. Critique will be held in the media center of the school.

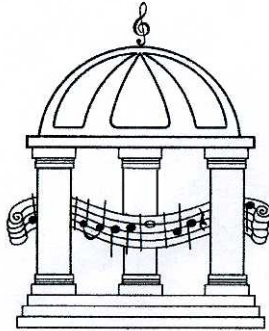

WHITE COLUMNS

## White Columns SAPA Contest February 13, 2010

Milton High School  
13025 Birmingham Highway  
Milton, Georgia

**Music:** Bring music to the sound table prior to performance. Make sure tapes are cued in the proper place. Sound testing will take place at the sound table during scheduled breaks only.  
**VOLUME IS CONTROLLED BY SAPA**

**Video Taping:** Due to copyright restrictions, **NO ONE, NOT EVEN THE CONTEST SPONSOR, is to video tape any part of the contest, EXCEPT a unit videotaping THEIR OWN performance.** One video pass will be provided to each unit at Unit Check-in. Contest video tapes **CANNOT BE SOLD.**

**Vendor Sales:** Vendor booths will be set up in the main central hallway leading to the Gym.

**Vendor cost is \$25.00 for a 10 X10 booth space.**

\*\*Please contact Melanie Kulamer at [kulamer@mindspring.com](mailto:kulamer@mindspring.com) for space availability and be prepared to supply contact name, email and phone number.

**Concessions:** Located in the upper gym, top floor. Concessions will be offered all day. Please fill out the attached pre-order form.

**First Aid:** Located in the upper area of the performance gym.

**PLEASE NOTE:** Units making housing and practice arrangements must settle their financial responsibilities at the unit check in when arriving to the show. Any unit with unsettled bills **WILL NOT** be allowed to compete.

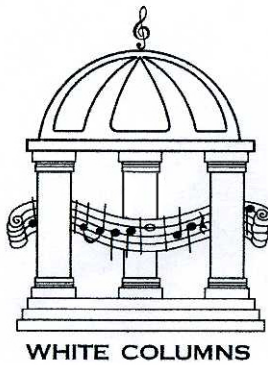

White Columns SAPA Contest  
February 13, 2010

Milton High School  
13025 Birmingham Highway  
Milton, Georgia

## Release Form

I \_\_\_\_\_, director of the \_\_\_\_\_  
\_\_\_\_\_ Winter Guard / Drumline understand that I  
am responsible for any damages that may occur by any member of my group  
during our stay. I also understand that Milton High School, the Milton High  
School Band or Milton High School Band Boosters are not liable for any lost or  
stolen items that may occur during the White Columns SAPA Contest, February  
13, 2010.

Number of Members \_\_\_\_\_ Signature \_\_\_\_\_

Please note: This form is due no later than at unit check in. Release forms may be sent in  
advance via fax:

Mark Kapral  
Milton H.S. Band  
Fax: 770-667-2844

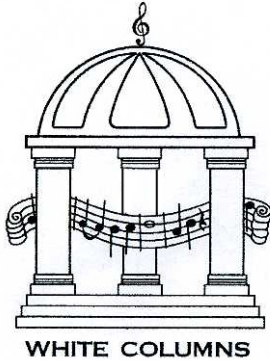

White Columns SAPA Contest  
February 13, 2010

Milton High School  
13025 Birmingham Highway  
Milton, Georgia

## Housing Contract

Unit Name: \_\_\_\_\_

Number of Marching Members: \_\_\_\_\_

Person to receive correspondence: \_\_\_\_\_

Address: \_\_\_\_\_

City, State, Zip: \_\_\_\_\_

Email: \_\_\_\_\_

Phone: \_\_\_\_\_

We would like to contract for overnight housing for a cost of \$3.00 per marching member as follows:

Arrive \_\_\_\_\_ at \_\_\_\_\_  
(day and date) (time)

Depart \_\_\_\_\_ at \_\_\_\_\_  
(day and date) (time)

All monies due will be paid at unit check in.

Make check payable to: Milton HS Band

Signed by: \_\_\_\_\_

Position: \_\_\_\_\_

Fax to: Mark Kapral  
Milton High School  
13025 Birmingham Highway  
Milton, GA 30004

Fax Number: 770-667-2844

**PAYMENT DUE AT CHECK IN**

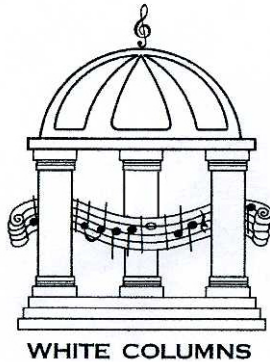

White Columns SAPA Contest  
February 13, 2010

Milton High School  
13025 Birmingham Highway  
Milton, Georgia

## Practice Site Contract

Unit Name: \_\_\_\_\_

Person to receive correspondence: \_\_\_\_\_

Address: \_\_\_\_\_

City, State, Zip: \_\_\_\_\_

Email: \_\_\_\_\_

Phone: \_\_\_\_\_

We would like to contract for hours of practice time as follows:

We would prefer times on \_\_\_\_\_ between \_\_\_\_\_ and \_\_\_\_\_  
date

We would prefer times on \_\_\_\_\_ between \_\_\_\_\_ and \_\_\_\_\_  
Date

*We understand the cost for practice to be \$20.00 per ½ hour. We also understand that if the contracted times are not used or needed, then we will still be obligated for the full price of the time contracted UNLESS suitable arrangements can be made with the contest sponsor PRIOR to the time assigned. The owed amount will be paid at unit check-in prior to competing.*

Make check payable to: Milton HS Band

Signed by: \_\_\_\_\_

Position: \_\_\_\_\_

Fax to: Mark Kapral  
Milton High School  
13025 Birmingham Highway  
Milton, GA 30004

Fax Number: 770-667-2844

**PAYMENT DUE AT CHECK IN**

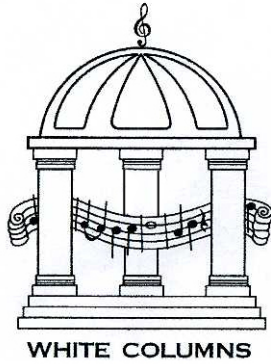

# White Columns SAPA Contest February 13, 2010

Milton High School  
13025 Birmingham Highway  
Milton, Georgia

## Unit Spiel Sheet

Please take care in completing this sheet, as it will be used for announcements. The way you fill this out is the way in which your unit will be announced. **PLEASE PRINT LEGIBLY (AND DEBATABLE WORDS SPELLED PHONETICALLY), TO AVOID MISPRONUNCIATION!!!!**

### Before the unit performs:

"Our next (first) unit in \_\_\_\_\_ class competition is  
\_\_\_\_\_ from \_\_\_\_\_."

The guard / drumline is managed by \_\_\_\_\_.

Instructors are \_\_\_\_\_.

Commanding Officer(s) is/are \_\_\_\_\_.

**(Directors:** Please write a brief description of you show **EXACTLY** as you wish it to be announced): \_\_\_\_\_  
\_\_\_\_\_.

"Are the judges ready?" **(Wait for a confirmation from the timing and penalty judge.)**

"Is the guard/drumline ready?" **(Wait for confirmation from the T and P judge.)**

"\_\_\_\_\_, you may take the floor in competition."

---

**As the unit is exiting:** "From \_\_\_\_\_, that was

\_\_\_\_\_. The guard/ drumline is managed by  
\_\_\_\_\_ and instructed by \_\_\_\_\_.

**(Directors:** List any awards, sponsors, etc. **EXACTLY** as you wish it to be announced.)

---

---

## White Columns Concession Pre-Order Form

To reduce your wait time in the concession line, we are offering a service to make this process more efficient. If you would like to pre-order for your group of 5 or more, please complete this form and fax or email it to us by **February 5<sup>th</sup>**.  
 Please fax to: Attn: Mark Kapral, Milton Band (770) 667-2844.  
 Please email to: Paula Makrides at makrides@fultonschools.org

This sheet maybe handed in the day of the event at unit check-in.  
 To ensure freshness, be sure to allow enough time before/after your show to pick up food.

Unit Name: \_\_\_\_\_ Contact phone # \_\_\_\_\_ Pick up time \_\_\_\_\_

<b>Item</b>	<b>Quantity</b>	<b>Price</b>	<b>Item Total</b>
BBQ Sandwich meal	_____	\$6.00	_____
Jimmy John's Subs:			
Turkey & Cheese 4"	_____	\$4.00	_____
Ham & Cheese 4"	_____	\$4.00	_____
Turkey & Cheese 8"	_____	\$6.00	_____
Ham & Cheese 8"	_____	\$6.00	_____
Hamburger meal	_____	\$5.50	_____
Cheeseburger meal	_____	\$5.75	_____
Hot Dog meal	_____	\$5.00	_____
 <b>Order Total</b>			 _____

All Meals come with chips and a drink.

Please provide total number of drink type for entire order:

Pepsi \_\_\_\_\_ Diet Pepsi \_\_\_\_\_ Dr. Pepper \_\_\_\_\_ Mountain Dew \_\_\_\_\_  
 Sierra Mist \_\_\_\_\_ Bottled Water \_\_\_\_\_

---

Concession Use Only

\_\_\_\_\_ Prepaid

\_\_\_\_\_ Paid at Unit Check in

\_\_\_\_\_ Pay at Concession Stand



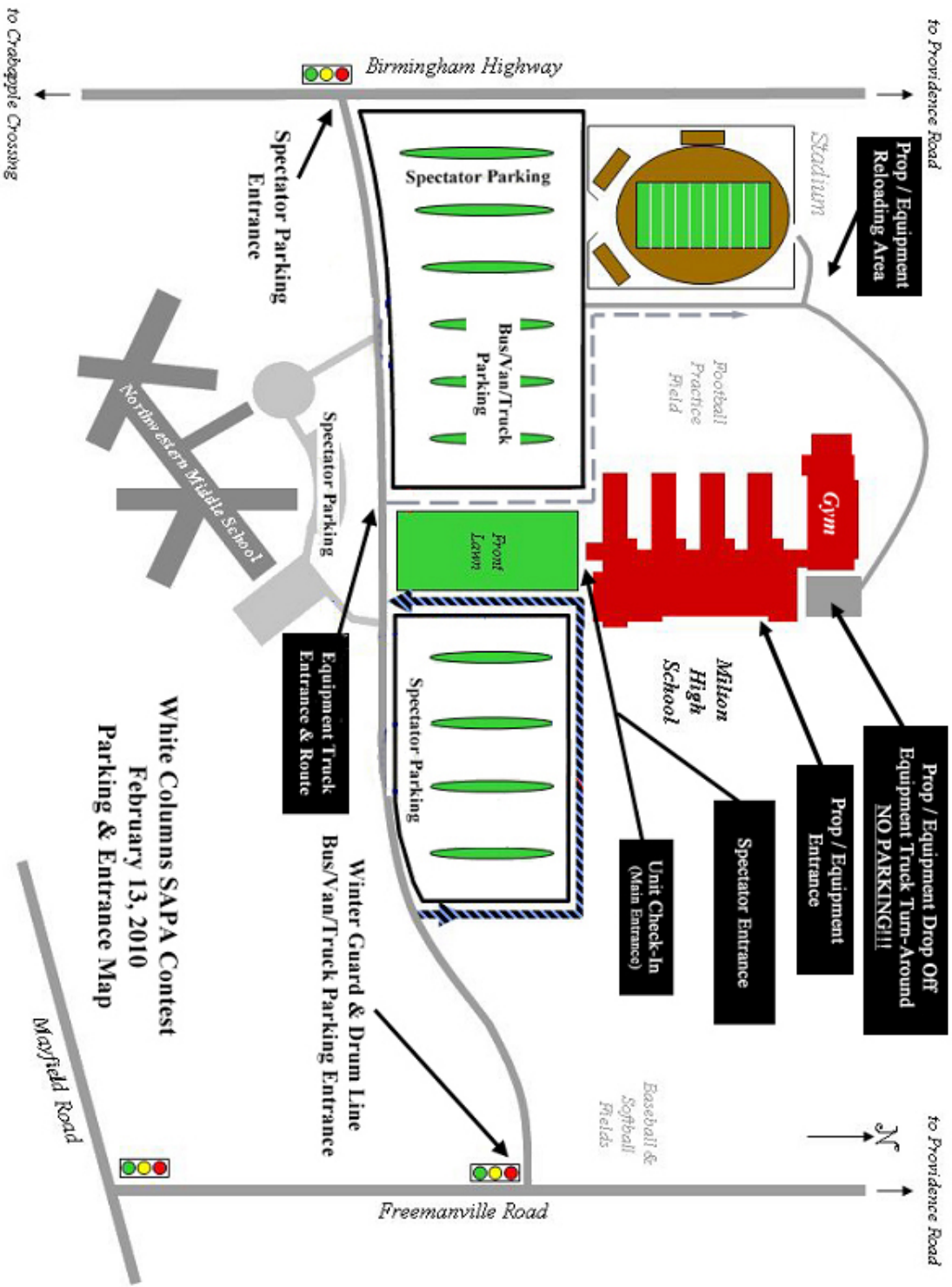

**White Columns SAPA Contest  
February 13, 2010  
Parking & Entrance Map**

# MILTON HIGH SCHOOL FIRST FLOOR

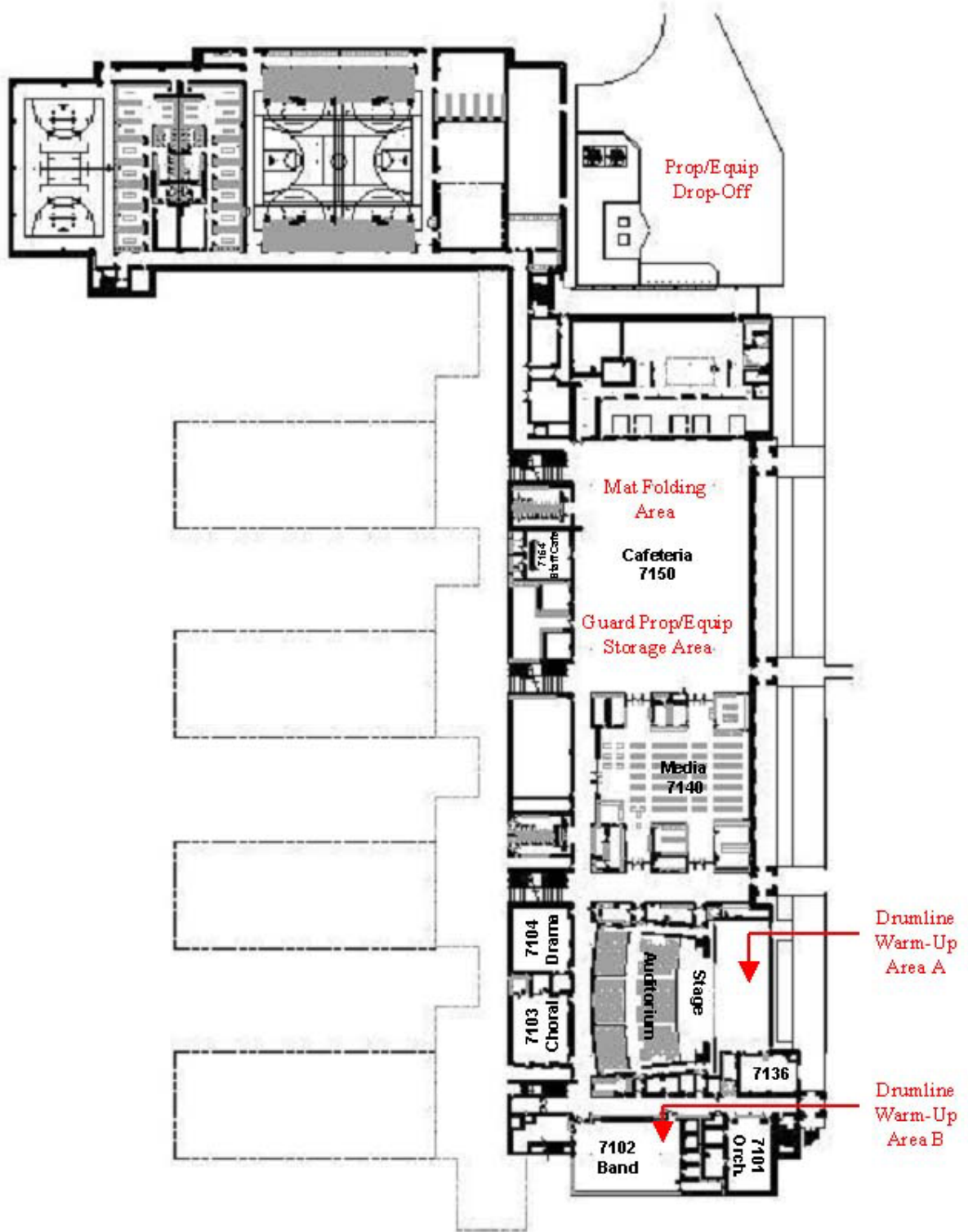

**White Columns SAPA Contest  
Performance and Warm-Up Area  
(Milton High School Gymnasium Area)**

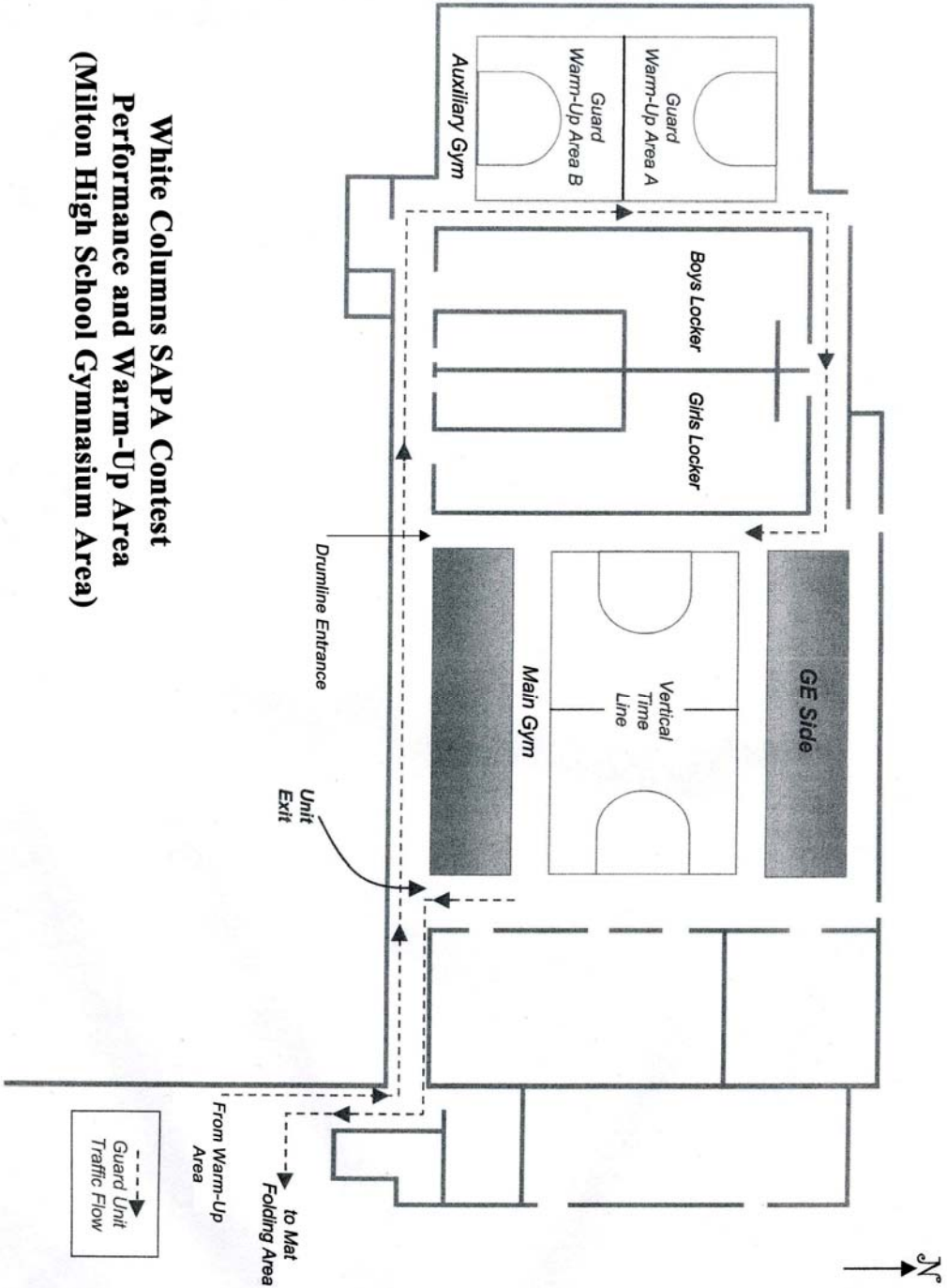

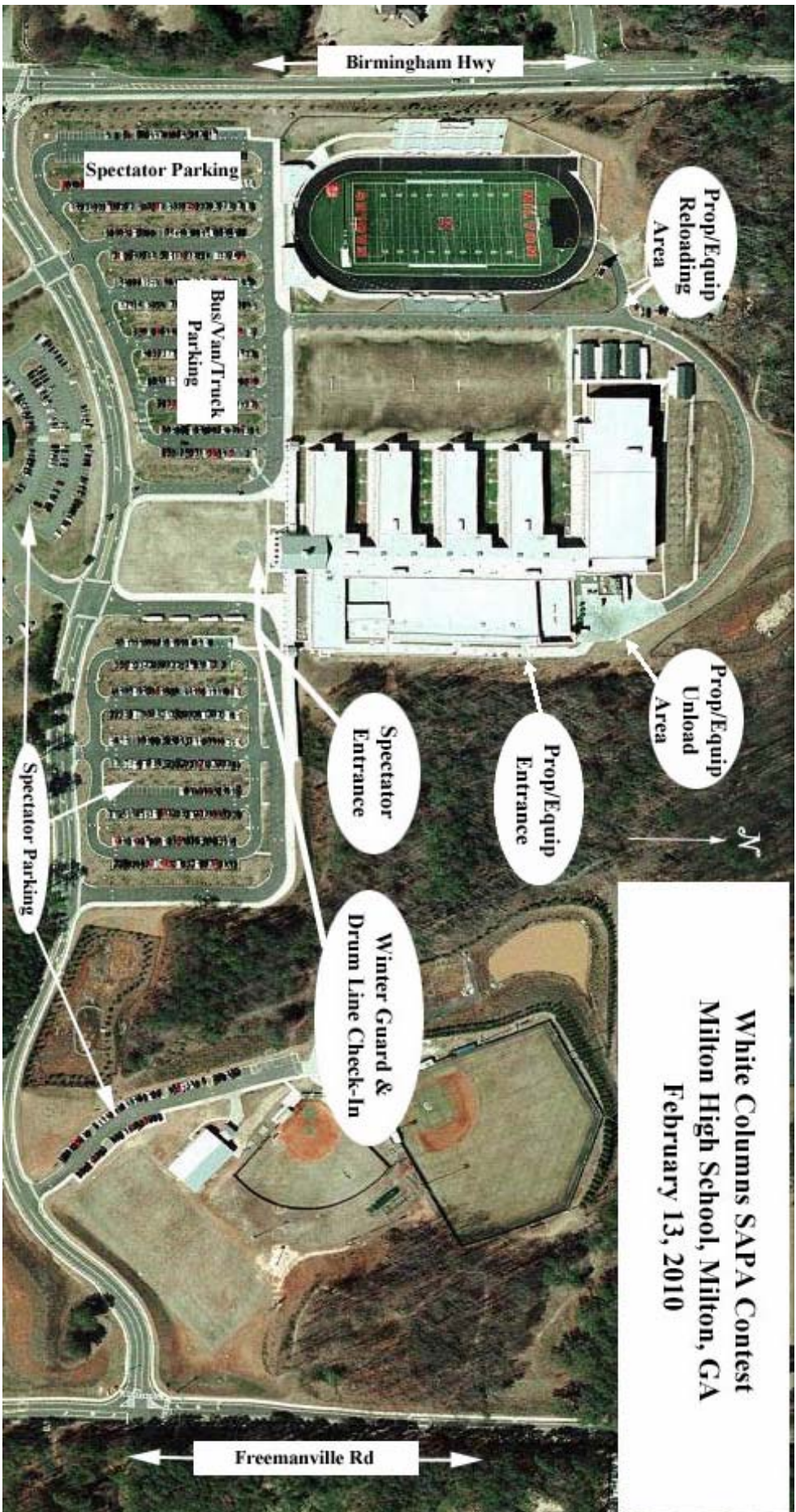

White Columns SAPA Contest  
Milton High School, Milton, GA  
February 13, 2010